

## ASME 90°エルボ (ロング) の形状・寸法・重量 / DIMENSIONS OF LONG RADIUS ELBOW

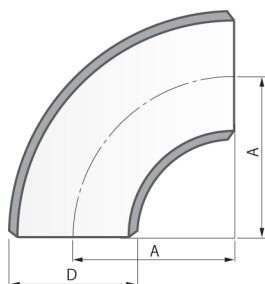

90° LONG RADIUS ELBOW



ASME B 16.9

Nominal Pipe Size (NPS)	Dimensions (Unit:mm)		Carbon & Alloy Steel Weight (Unit:kg)														Stainless Steel Weight (Unit:kg)			
	Outside Diameter at Bevel	Center - to - End 90 Deg Elbow																		
			D	A	STD	XS	XXS	S40	S80	S120	S160	S10	S20	S30	S60	S100	S140	S10S	S40S	S80S
1/2	21.3	38	0.078	0.097	0.152	0.078	0.097	-	0.117	-	-	-	-	-	-	0.060	0.080	0.100	0.120	
3/4	26.7	38	0.104	0.134	0.225	0.104	0.134	-	0.176	-	-	-	-	-	-	0.090	0.110	0.130	0.180	
1	33.4	38	0.150	0.194	0.326	0.150	0.194	-	0.253	-	-	-	-	-	-	0.130	0.160	0.200	0.255	
1-1/4	42.2	48	0.254	0.335	0.583	0.254	0.335	-	0.421	-	-	-	-	-	-	0.210	0.250	0.350	0.425	
1-1/2	48.3	57	0.364	0.486	0.858	0.364	0.486	-	0.651	-	-	-	-	-	-	0.300	0.390	0.500	0.658	
2	60.3	76	0.651	0.895	1.610	0.651	0.895	1.120	1.330	-	-	-	-	-	-	0.500	0.690	0.900	1.340	
2-1/2	73.0	95	1.290	1.710	3.050	1.290	1.710	1.480	2.230	-	-	-	-	-	-	0.800	1.340	1.750	2.250	
3	88.9	114	2.030	2.740	4.970	2.030	2.740	2.910	3.830	-	-	-	-	-	-	1.280	2.050	2.770	3.870	
3-1/2	101.6	133	2.820	3.900	7.130	2.820	3.900	-	5.830	-	-	-	-	-	-	1.620	2.870	3.950	5.890	
4	114.3	152	3.850	5.340	9.820	3.850	5.340	6.760	8.030	-	-	-	-	-	-	2.180	3.900	5.420	8.110	
5	141.3	191	6.510	9.260	17.20	6.510	9.260	12.00	14.70	-	-	-	-	-	-	3.960	6.580	9.300	14.80	
6	168.3	229	10.10	15.30	28.40	10.10	15.30	19.50	24.20	-	-	-	-	-	-	5.850	10.20	15.50	24.40	
8	219.1	305	20.40	30.90	51.70	20.40	30.90	43.20	53.30	-	20.40	20.40	-	-	-	10.30	21.60	31.20	-	
10	273.0	381	36.10	48.80	92.80	36.10	57.30	79.50	103.0	-	36.10	36.10	-	-	-	16.80	36.60	49.20	-	
12	323.8	457	53.00	70.00	134.0	57.20	94.70	134.0	171.0	-	53.00	53.00	78.20	134.0	171.0	28.60	53.50	70.70	-	
14	355.6	533	68.10	90.00	-	79.10	132.0	188.0	236.0	68.10	68.10	68.10	106.0	188.0	236.0	36.60	79.90	-	-	
16	406.4	610	89.20	118.0	-	118.0	195.0	274.0	350.0	89.20	89.20	89.20	153.0	274.0	350.0	72.10	180.7	-	-	
18	457.0	686	113.0	150.0	-	168.0	274.0	391.0	495.0	113.0	113.0	150.0	221.0	391.0	440.0	-	-	-	-	
20	508.0	762	140.0	186.0	-	219.0	372.0	528.0	676.0	140.0	140.0	186.0	296.0	528.0	676.0	-	-	-	-	
22	559.0	838	170.0	225.0	-	280.0	492.0	693.0	884.0	170.0	170.0	225.0	-	693.0	884.0	-	-	-	-	
24	610.0	914	202.0	269.0	-	366.0	634.0	918.0	1160	202.0	202.0	366.0	510.0	918.0	1160	-	-	-	-	